

THE CITY OF  
**MELFORT**  
SASKATCHEWAN

**BASIC PLANNING  
STATEMENT**

**LAND USE CONCEPT**

**MAP NO. 1**



THIS IS THE BASIC PLANNING STATEMENT REFERRED TO  
IN BYLAW NUMBER \_\_\_\_\_ ADOPTED BY THE URBAN  
MUNICIPALITY OF MELFORT

MAYOR \_\_\_\_\_

ADMINISTRATOR \_\_\_\_\_

APPROVED ON THE \_\_\_\_\_ DAY OF \_\_\_\_\_  
19\_\_\_\_ A.D.

DEPUTY MINISTER OF MUNICIPAL GOVERNMENT

● **NEIGHBOURHOOD  
COMMERCIAL**



Designed by E. G. PEACE C.E.  
Planning and Advisory Services  
Saskatchewan Municipal Government  
Regina, Saskatchewan  
This map was derived from the  
Provincial Standard Urban Control Dataset.  
© 1984 Saskatchewan Property Management Corporation  
Central Survey and Mapping Agency

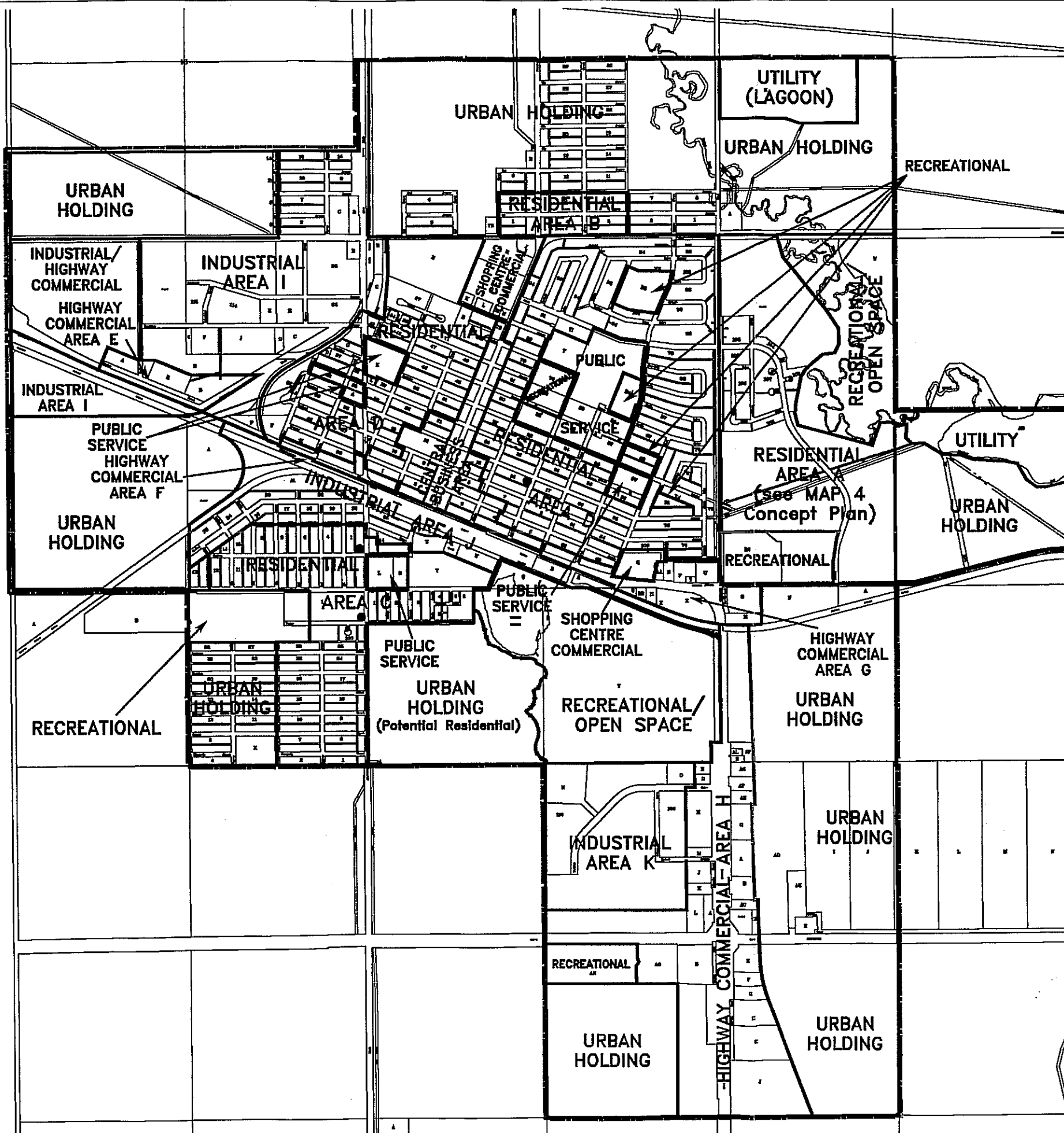

THE CITY OF  
**MELFORT**  
SASKATCHEWAN

**BASIC PLANNING  
STATEMENT**

**Generalized Land Use**

MAP NO. 2

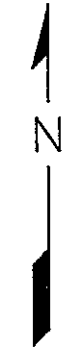

- Ⓜ INDUSTRIAL USE
- Ⓡ RESIDENCE
- Ⓤ UTILITY

Cartography by E. D. PEACE, C.C.  
Printing and Layout Service  
Saskatchewan Municipal Government  
Regina, Saskatchewan  
This map was prepared from the  
Provincial Wetland Urban Cultural District  
© 1984 Saskatchewan Property Management Corporation  
Land Survey and Mapping Agency

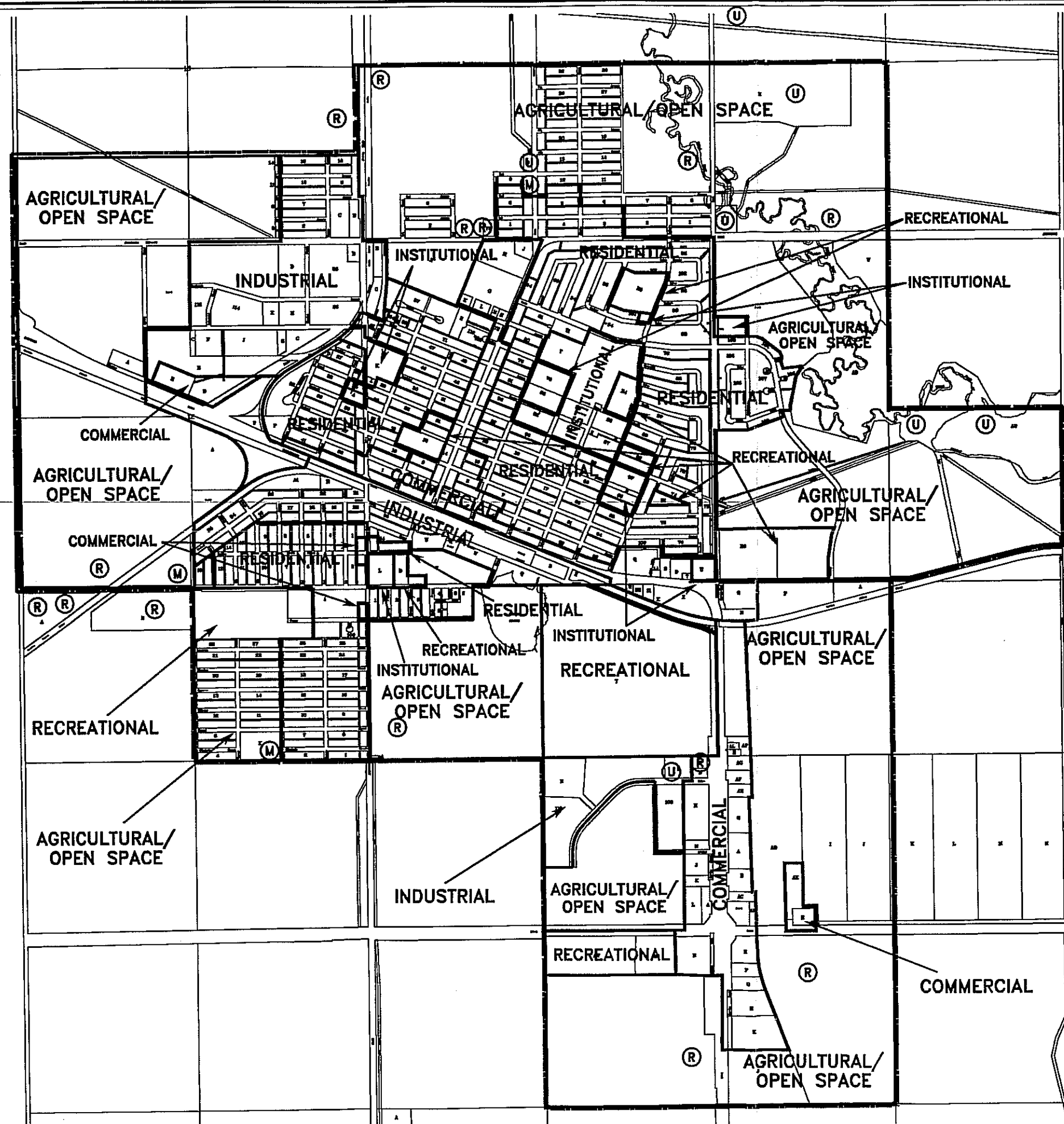

THE CITY OF  
**MELFORT**  
SASKATCHEWAN

**BASIC PLANNING  
STATEMENT**

**DEVELOPMENT CONSTRAINTS**

MAP NO. 3



**LEGEND**

- Low-lying Area
- Flood Damage Reduction Program-Hazard Area
- Utility Easement
- Broadway Elementary (.8 km/.5 mile radius)
- Burke Elementary (.8 km/.5 mile radius)
- Brunswick Elementary (.8 km/.5 mile radius)
- High School (1.2 km/.75 mile radius)

Cartographer: R. G. PARCE C.C. Planning and Land Use Services  
This plan was prepared from the 1984 Saskatchewan Property Management Corporation Control Survey and Mapping Agency

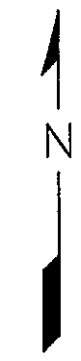

THE CITY OF  
**MELFORT**  
SASKATCHEWAN

**BASIC PLANNING  
STATEMENT**

**RESIDENTIAL AREA A  
CONCEPT PLAN**

MAP NO. 4

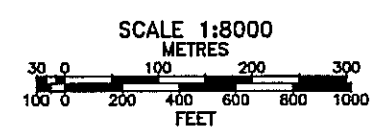

Developed by E. G. PEARCE C.E.  
Planning and Surveying Services  
Saskatchewan Municipal Government  
Regina, Saskatchewan  
This base map was derived from the  
Provincial Standard Urban Coloured Release  
© 1984 Saskatchewan Property Management Corporation  
Control Survey and Mapping Agency

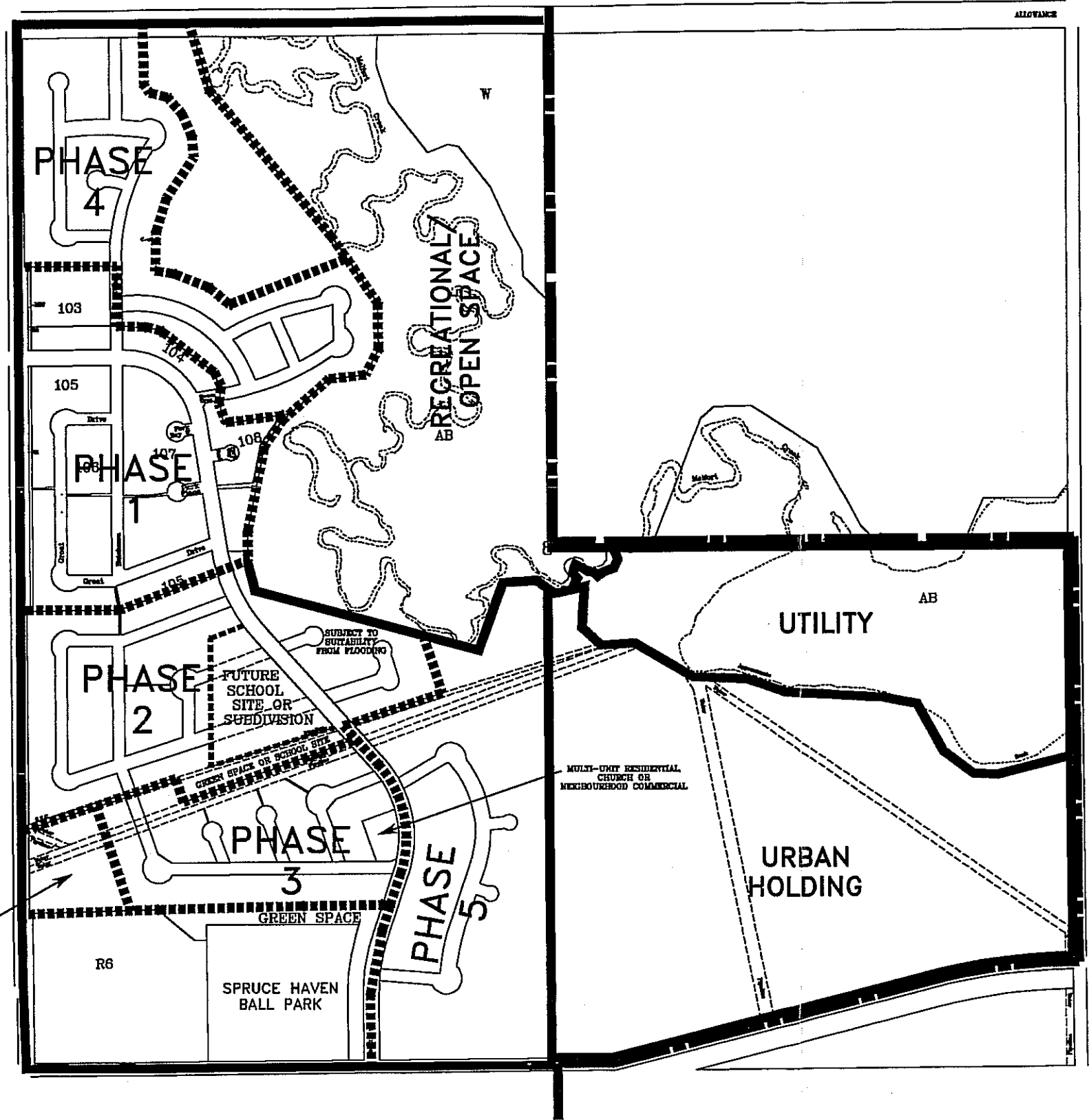

MULTIPLE  
UNIT  
RESIDENTIAL

PHASE  
4

103

105

PHASE  
1

PHASE  
2

PHASE  
3

PHASE  
5

RECREATIONAL  
OPEN SPACE

SPRUCE HAVEN  
BALL PARK

UTILITY

URBAN  
HOLDING

R6

AB

MULTI-UNIT RESIDENTIAL,  
CHURCH OR  
NEIGHBOURHOOD COMMERCIAL

FUTURE  
SCHOOL  
SITE OR  
SUBDIVISION

GREEN SPACE OR SCHOOL SITE

GREEN SPACE

ALLOWANCE

THE CITY OF  
**MELFORT**  
SASKATCHEWAN

**BASIC PLANNING  
STATEMENT**

**HIGHWAY COMMERCIAL AND  
INDUSTRIAL CONCEPT PLANS**

MAP NO. 5

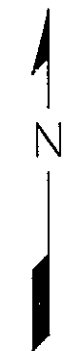
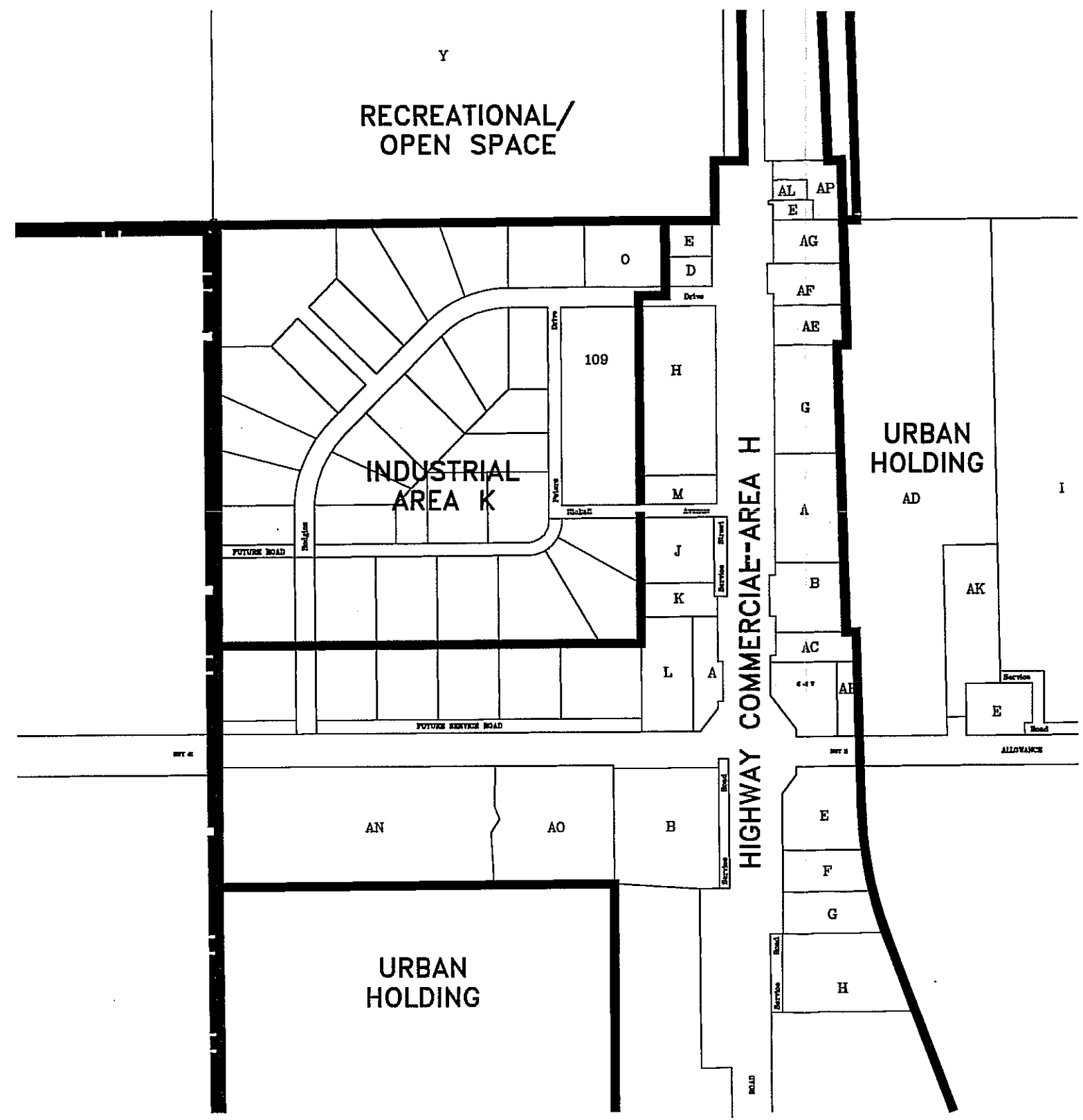
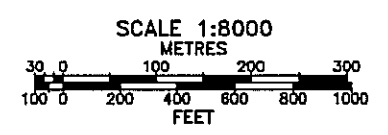

Cartography by E. G. PEACE C.C.  
Planning and Advisory Services  
Saskatchewan Municipal Government  
Regina, Saskatchewan  
This base map was derived from the  
Provincial Land Use Control Dataset,  
© 1984 Saskatchewan Property Management Corporation,  
Control Survey and Mapping Agency



THE CITY OF  
**MELFORT**  
SASKATCHEWAN

**BASIC PLANNING  
STATEMENT**

**WATER SYSTEM**

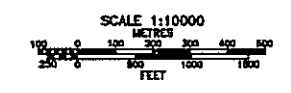
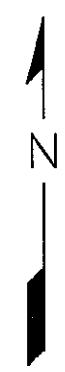
MAP NO. 6



-  WATER SYSTEM
-  REGIONAL WATER LINE
-  RAW WATER LINE

Cartography by E. G. PLANKS C.C.  
Planning and Advisory Services  
Saskatchewan Municipal Government  
Regina, Saskatchewan  
  
This map was derived from the  
Provincial Electoral Map Catalogue Dataset.  
© 1984 Saskatchewan Property Management Corporation  
Central Survey and Mapping Agency

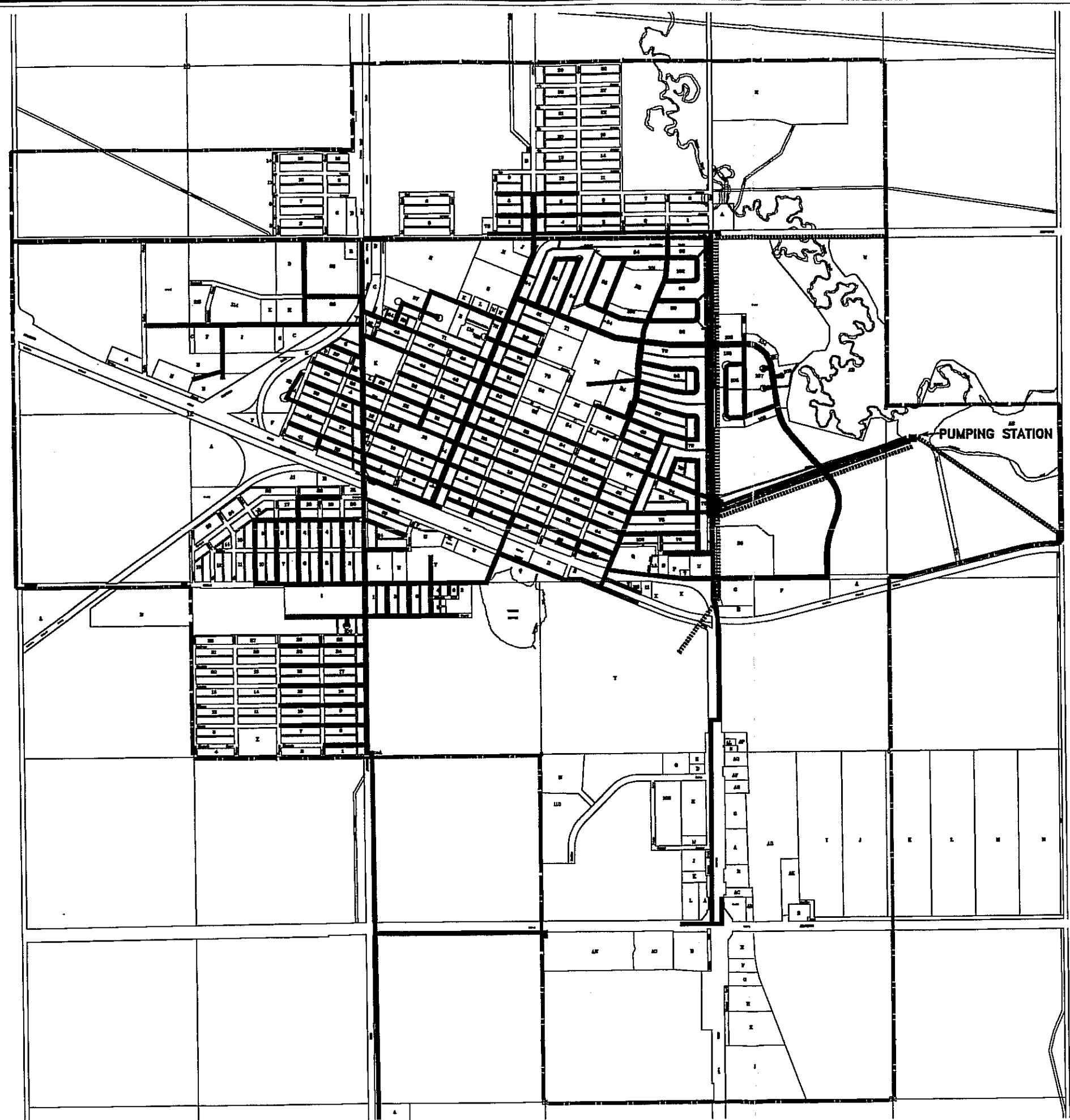





THE CITY OF  
**MELFORT**  
SASKATCHEWAN

**BASIC PLANNING  
STATEMENT**

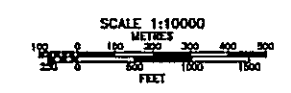
**SANITARY AND STORM  
WATER SEWER SYSTEMS**

MAP NO. 7



-  SANITARY SEWER
-  STORM SEWER
-  PUMPING STATION

Orthography by E. G. PEACE C.C.  
Planning and Advisory Services  
Saskatchewan Municipal Government  
Regina, Saskatchewan  
This base map was derived from the  
Provincial Standard Grid Co-ordinated Dataset.  
© 1992 Saskatchewan Property Management Corporation  
Central Survey and Mapping Agency

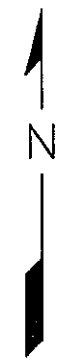
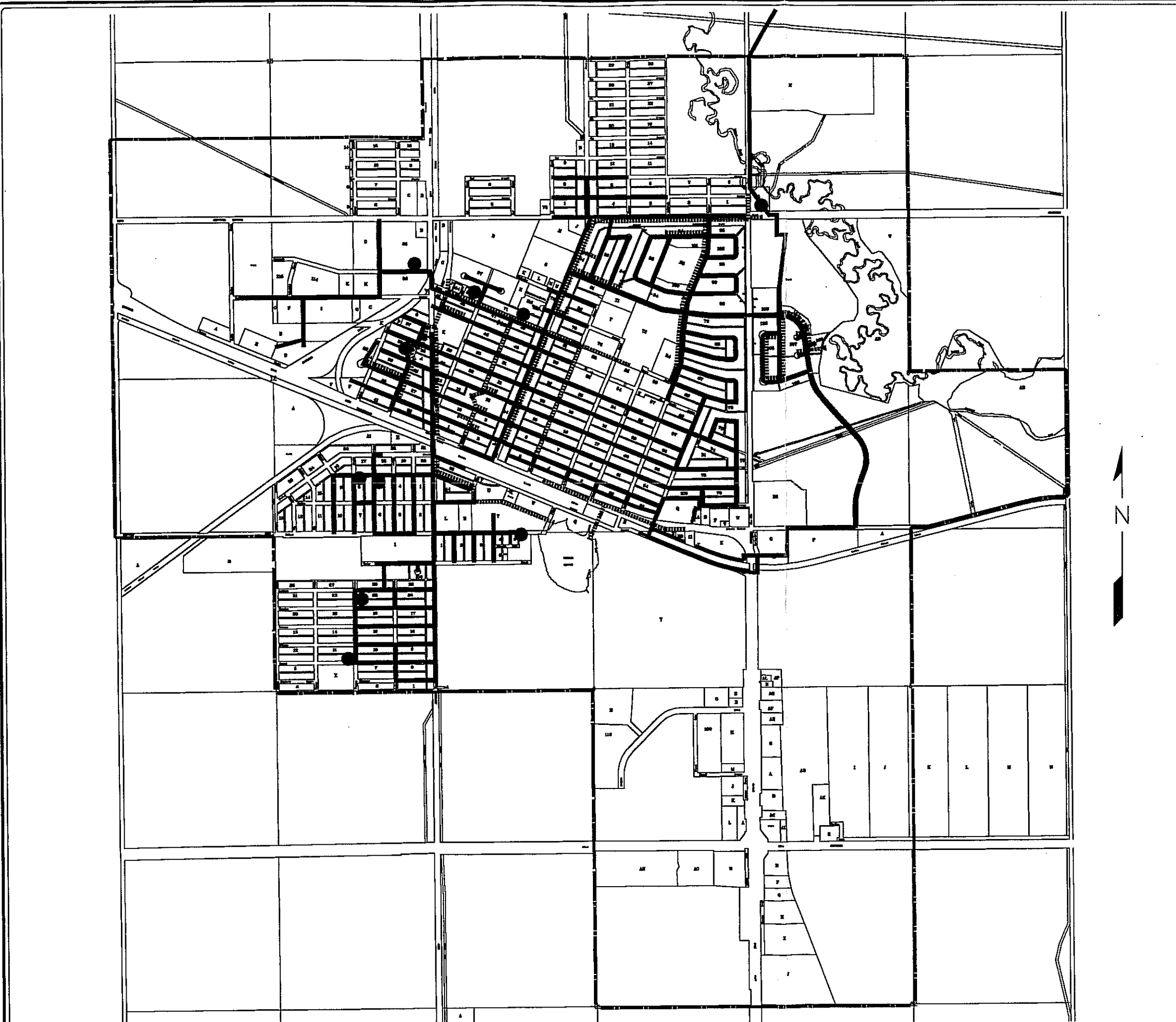

THE CITY OF  
**MELFORT**  
SASKATCHEWAN

**BASIC PLANNING  
STATEMENT**

**ROADWAY NETWORK PLAN**

MAP NO. 8



SCALE 1:20000  
METRES  
0 100 200 300 400 500  
FEET  
0 500 1000 1500

————— ARTERIAL STREET  
- - - - - COLLECTOR STREET

INFORMATION SOURCE: STANLEY ASSOCIATES ENGINEERING LTD.  
CITY OF MELFORT  
TRANSPORTATION STUDY

Cartography by R. D. PEACE C.C.  
Planning and Advisory Services  
Saskatoon, Saskatchewan  
Regina, Saskatchewan

This base map was derived from the  
Provincial Standard Urban Control District  
© 1984 Saskatchewan Property Management Corporation  
Central Survey and Mapping Agency

